

**Accessories**

**Straight Guide with Micro Adjustment**  
Part No. 195136-9



To install the straight guide assembly and trimmer guide assembly

**Holder Assembly**  
Part No. 122G61-3



**Rod 8**  
L=255 mm  
Part No. 256861-8  
2 pieces required

L=450 mm  
Part No. 195137-7  
2 pieces set



**Straight Guide**  
Part No. 342428-9  
Use with Holder Assembly and Rod 8 x2



**Trimmer Guide Assembly**  
Part No. 123022-4 / 122699-2  
Use with Holder Assembly and Rod 8 x2



**Guide Rail Adapter**  
(Use with Guide Rail)  
Part No. 194579-2



**Guide Rail**  
(Use with Guide Rail Adapter)

Length	Part No.
1.0 m	199140-0
1.4 m	194368-5 / 191J17-5
1.5 m	199141-8
1.9 m	194925-9 / 194926-7
3.0 m	194367-7



**Clamp Set**  
(Use with Guide Rail)

Standard type  
Part No. 194385-5



Quick type  
Part No. 199826-6



Push clamp type  
Part No. 1913K5-7



**Dust Nozzle**  
Part No. 194934-8



**Collet Cone**

Size	Part No.
12 mm	763628-2
1/2"	763622-4
13 mm	763632-1



**Collet Sleeve**  
For the use of bits with smaller diameters



From	To	Part No.
6 mm	6 mm	763801-4 / 763811-1
	6.35 mm	763808-0
12 mm	8 mm	763804-8 / 763812-9 A-86206
	10 mm	763807-2
	1/4"	763803-0 / 763809-8
1/2"	3/8"	763805-6 / 763810-3
	10 mm	763806-4

**Templet Guide**  
(For fast production of complicated shapes by using templets.)

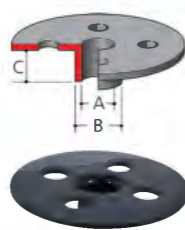

A (mm)	B (mm)	C (mm)	Part No.
7.7	9.5	11.5	164379-4
9	11	13	164775-6
10	12	9	164388-3
11	12.7	13	164776-4
14	17	20	165366-6
14.5	16	13	344364-5 / 345387-6 193043-0
18	20	13	164393-0
22	24	13	165364-0
24	27	13	164470-8 / A-86212
25	29	15	163080-8
27	30	13	164471-6
37	40	13	164472-4 / 165046-4

**Charging Time**

Battery	Fast Charging	
	DC40RA	DC40RC
*1 BL4020 2.0Ah	22 min	30 min
*1 BL4025 2.5Ah	28 min	38 min
*1 BL4040/F 4.0Ah	45 min	67 min
*1 BL4050/F 5.0Ah	50 min	85 min
BL4080F 8.0Ah	76 min	170 min

\*1 Recommended battery

Cordless Router	
RP001G 12 mm / - ( - / 1/2")	
	Variable Speed
	Brake
	Constant Speed
	Soft Start
	Dust Collection
	Built-in Job Light
	Anti-restart function
	Carrying Case
	Collet size 12 mm / - ( - / 1/2") Base size 150 x 130 mm (5-7/8 x 5-1/8") Plunge capacity 60 mm (2-3/8") No load speed 8,000-25,000 min <sup>-1</sup> Vibration level 6.3 m/s <sup>2</sup> Vibration K factor 1.5 m/s <sup>2</sup> Sound pressure level 92 dB(A) Sound power level 100 dB(A) Noise K factor 3 dB(A) Dimensions (L x W x H) 135 x 275 x 288 mm (5-5/16 x 10-7/8 x 11-3/8") Dimensions (Battery) BL4025 Net weight 4.0 - 5.2 kg (8.8 - 11.5 lbs.) Net weight (Battery) BL4025 - BL4080F
	<b>Standard Equipment :</b> Wrench, Collet sleeve, Templet guide, Dust nozzle, Straight guide, Holder, Rod, Chip deflector, Straight bit, Battery, Charger

The weight may differ depending on the attachment(s), including the battery cartridge. The lightest and heaviest combination, according to EPTA-Procedure 01/2014, are shown in the table.  
Items of standard equipment and specifications may vary by country or area.

**Makita**® Cordless Router  
RP001G 12 mm / - ( - / 1/2")

**XGT**  
**40V Li-ion max**



Net weight  
**4.0 kg**  
■ Battery : BL4025

Work amount  
Work amount on a single full battery charge  
**About 80 m**  
■ 1,000 mm MDF was cut  
■ ø12 mm straight bit and at a cutting depth of 6 mm  
■ Battery : BL4040



## Excellent combination of high efficiency and lightweight design

### Lightweight design

Net weight  
**4.0 kg**  
(with BL4025)



### Low overall height

Overall height  
Lower dead point  
**228 mm**  
(with BL4025)

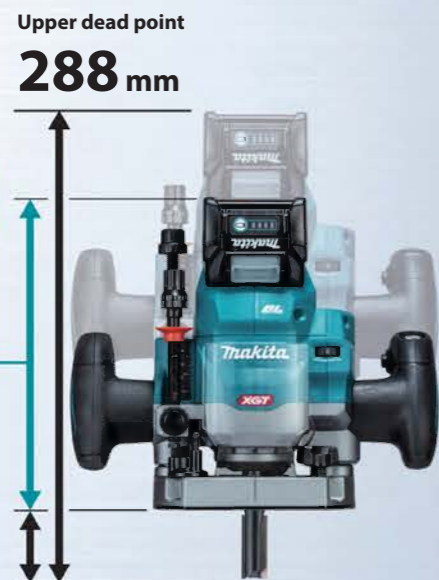

### High power Brushless motor

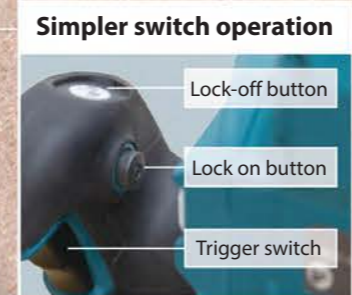

**Speed control dial**  
Enables selection of the rotation speed to suit various workpieces.

Number	Speed
1	8,000 min <sup>-1</sup>
2	12,500 min <sup>-1</sup>
3	17,000 min <sup>-1</sup>
4	21,000 min <sup>-1</sup>
5	25,000 min <sup>-1</sup>

Constant speed control reduces the chance of a drop in cutting speed even when using a  $\varnothing 12$  mm bit, reducing the roughness of the cutting surface.



### **AWS** Auto-start Wireless System

Connects to compatible vacuum cleaners with Bluetooth. The vacuum cleaner automatically runs while the switch is on.

### Bluetooth



**Lock lever**  
Enables easy depth locking.



**3 stage cut depth adjustment**  
Select the stopper screw by rotating the stopper base.



**Shaft lock**  
The flat-top design provides stability, making bit changes easier.



**LED job light**  
A press of the Lock-off button turns the tool on in the standby mode and with the LED job light on for better view of the cutting position.



**Can be connected to Vacuum with Dust nozzle and Hose.**



**Soft start and soft brake**  
Prevents damage to the workpiece material due to recoil.

**Compatible with 12 mm or 1/2" Collet chuck**



**XPT**  
(eXtreme Protection Technology)

